

**Thermakraft**

# ALUBAND™

## Window Sealing System

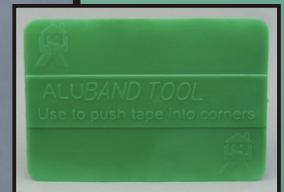

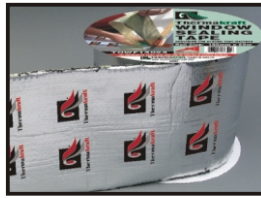

## APPLICATION AND INSTALLATION

### Product Description

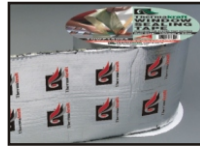

**Thermakraft ALUBAND™** is a polymeric faced, modified bituminous self adhesive tape with a release backing film.

The **Thermakraft ALUBAND™ Corner Moulded Piece™** is made from inert polyethylene and is coloured orange. It is used in conjunction with the **Thermakraft ALUBAND™ Tape** and the building underlay.

The **Thermakraft ALUBAND™ Tool** is used to ensure proper adhesion of the tape to the building underlay.

### Product Advantage

**Thermakraft ALUBAND™ Window Sealing System** is used around framed joinery openings as a secondary weather barrier. **Thermakraft ALUBAND™** is suitable for use in all Building Wind Zones of NZS 3604 up to, and including “Very High”.

### Application

- 1** Cut the wall underlay/air barrier at a 45° angle away from each corner (*left pic*). Fold flaps tightly into the window or door opening and fix with staples on the back faces of the framing (*right pic*). Trim excess wall underlay, to enable unimpeded access to the opening.

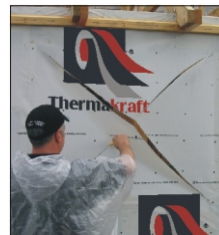

- 2** Fix the **Thermakraft ALUBAND™ Corner Moulded Piece** to the sill corners by way of staples or clouts to the two jambs as shown. The flexibility of the corner piece allows for a 5° chamfer (slope) on the timber sill where it is required for direct fix cladding. Now install the **ALUBAND™** as in step 3. **Always ensure that ALUBAND™ is applied to surfaces that are clean and free of dust, contaminants, solvents, oils or waxes.**

**Note the following:** 150mm wide tape is used for 100mm wide window or door framing, and the 200mm wide tape is used for 140mm to 150mm wide reveals. (With steel framed houses use Double Sided Tape to attach **Thermakraft ALUBAND™ Corner Moulded Piece** to metal cladding).



- 3** Measure 200mm up both jambs (*left pic*), add 400mm to the length of the window sill and cut the **ALUBAND™** to suit that measurement (*right pic*).



# APPLICATION AND INSTALLATION . . . contd

- 4** **ALUBAND™** should not be applied directly on to timber, or indirectly on to a timber sheathed in underlay that has been freshly LOSP treated. Always allow the solvent to fully flash off prior to wrapping in underlay and applying **ALUBAND™**. Remove first the polyethylene release film from the **ALUBAND™**; align the back edge of the **ALUBAND™** with the inside edge of sill.

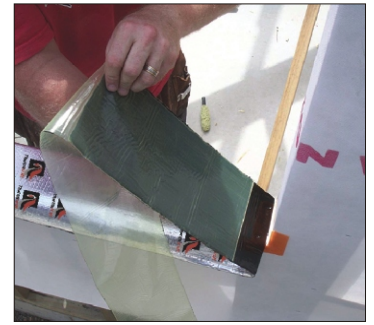

- 5** Using the **Thermakraft ALUBAND™ Tool**, firmly press the **ALUBAND™** onto the wall underlay to ensure good adhesion. Using the **Thermakraft ALUBAND™ Tool**, ensure the tape is fitted tightly into the jamb to sill corners.



- 6** At the sill/jamb corners cut the **ALUBAND™** from the external edge of the frame outwards. Fold flaps (**ALUBAND™**) back onto the wall underlay/air barrier and press tape firmly for good adhesion.



- 7** Proceed to fix the **ALUBAND™** to the top corners of the frame (200mm across lintel x 200mm down jamb). Remove first the release film from the **ALUBAND™**; align the back edge of the **ALUBAND™** with inside edge of lintel. Using the **Thermakraft ALUBAND™ Tool**, ensure that the tape is fitted tightly into the corners. Cut the **ALUBAND™** from the external edge of the frame outwards. Fold flaps (**ALUBAND™**) back onto the wall underlay and press tape firmly for good adhesion.



- 8** For window or door lintel to jamb junction, apply a Butterfly using the 50mm wide x 100mm long **ALUBAND™**. Fix at a 45° angle to the jamb with an overlap at the corner of 3mm (as per photo on right). After the installation of **ALUBAND™**, ensure that the edges do not come into contact with solvent based sealants or adhesives. Solvents in these products can adversely affect the **ALUBAND™** adhesion or dissolve the bituminous adhesive and cause it to run. If the application of solvent based adhesives or sealants are necessary, cover the edges with **Thermakraft 48mm 403F, 493F** or equivalent foil tape to form a barrier.



# APPLICATION AND INSTALLATION . . . contd

- 9** Meter boxes with built-in flanges, to be taped with 50mm **ALUBAND™** along each flange to the building underlay. (Refer steps 1-8).

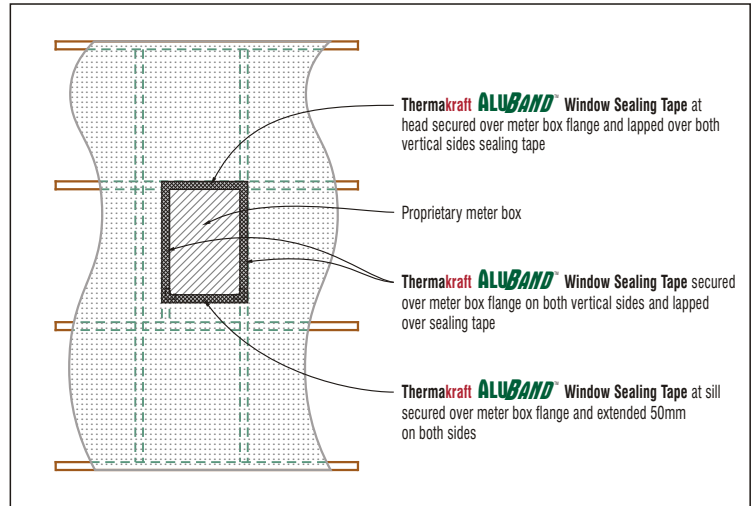

- 10** 50mm **ALUBAND™** is used to seal the up stand of the window head flashing to the building underlay. Refer to the cladding manufacturer's details.

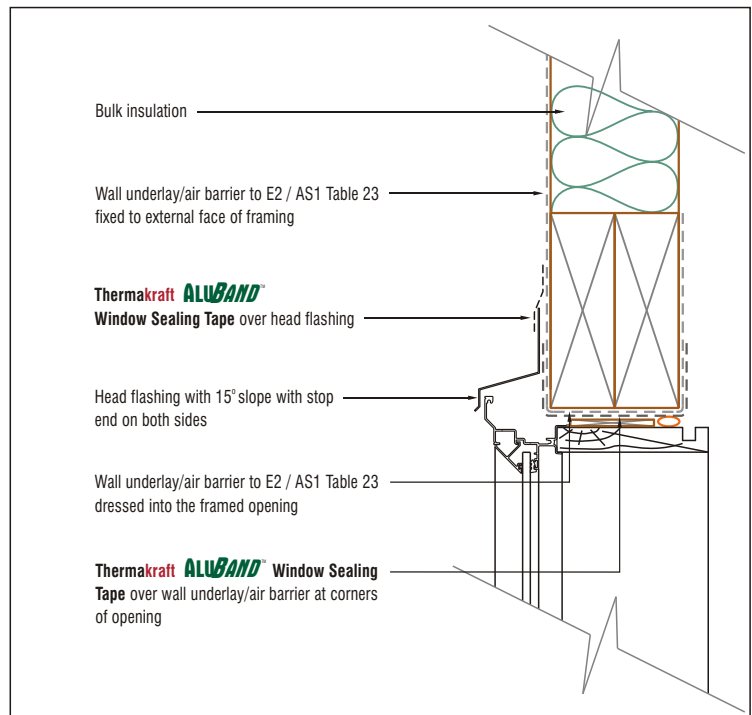

- 11** Door frames are to be treated similarly to window openings. The sill may be either a timber or a concrete floor.

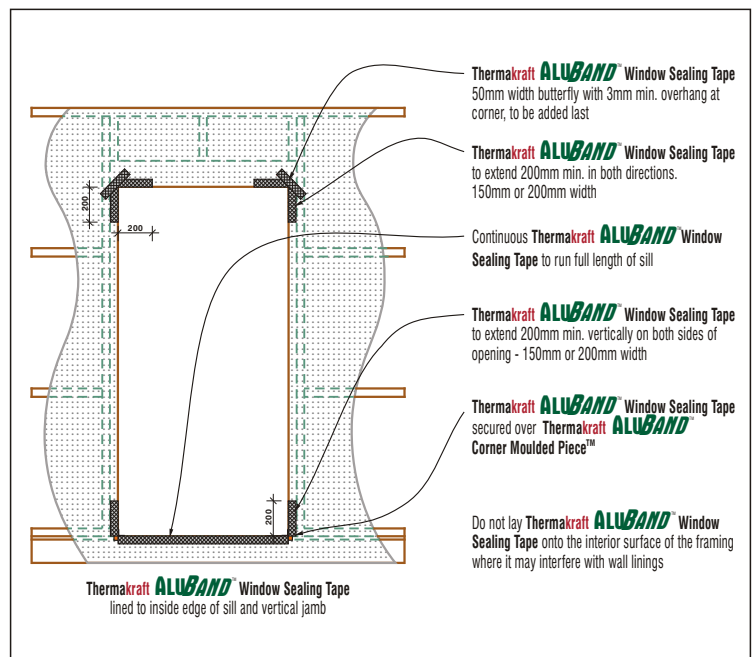

# ALUBAND™

## Window Sealing System

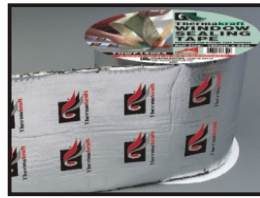

### Storage

Thermakraft ALUBAND™ Window Sealing System must be stored in clean dry conditions and not in an area with direct sunlight.

### Roll Dimensions

200mm x 25m = 2 rolls per ctn  
150mm x 25m = 4 rolls per ctn  
75mm x 25m = 8 rolls per ctn

50mm x 25m = 12 rolls per ctn  
150mm x 10m = 12 rolls per ctn

### House Pack:

3 x 150mm x 25m rolls / 3 x 50mm x 10m rolls / 1 x pkt Thermakraft ALUBAND Corner Moulded Pieces / 1 x Thermakraft ALUBAND Tool.

# ALUBAND

## Pipe Sealing Method

ALUBAND adhesive may affect Polybutene pipes, and should not be used to seal penetrations around Polybutene pipe systems.

### STEP 1

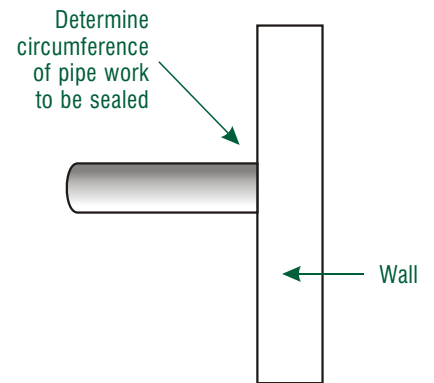

PIPE/WALL JOINT

### STEP 2

Cut a length of ALUBAND 20% longer than circumference

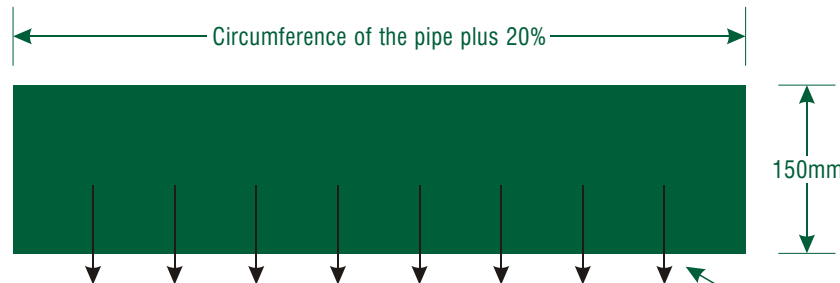

Make cuts along one edge of ALUBAND at 20mm intervals

### STEP 3

Wrap ALUBAND around pipe and flare out cut strips onto adjacent pipe work

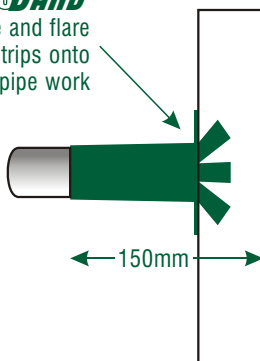

### STEP 4

ALUBAND attached to pipe work

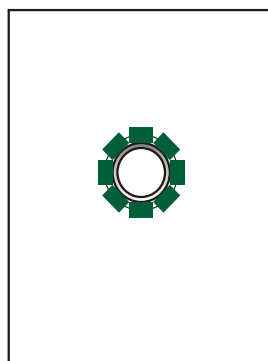

END VIEW

### STEP 5

Cut four BUTTERFLY ALUBAND strips 150mm x 50mm and attach to pipe work as shown

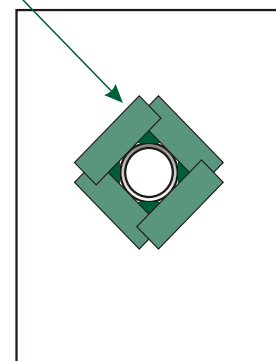

END VIEW

# TECHNICAL SPECIFICATIONS

**Thermakraft ALUBAND™ Window Sealing System** can be used as a flexible flashing system around window and door joinery openings on timber framed buildings within the following scope:

- the scope limitations of NZBC Acceptable Solution E2/AS1, Paragraph 1.1; and,
- with a risk score of 0-20, calculated in accordance with NZBC Acceptable Solution E2/AS1, Table 2; and,
- with wall cladding systems complying with NZBC Acceptable Solution E2/AS1; and,
- with wall underlays compatible with the flashing tape; and,
- situated in NZS 3604 Building Wind Zones up to, and including “Very High”.

**Thermakraft ALUBAND™** can be used as a flexible flashing system around window and door joinery openings on steel framed buildings within the following scope:

- the scope limitations of NZBC Acceptable Solution E2/AS1; and,
- constructed with steel framing complying with the NZBC; and
- with a risk score of 0-20, calculated in accordance with NZBC Acceptable Solution E2/AS1, Table 2; and with wall cladding systems complying with NZBC Acceptable Solution E2/AS1; and,
- with wall underlays compatible with the flashing tape; and,
- situated in NZS 3604 Building Wind Zones up to, and including “Very High”.

**Thermakraft ALUBAND™** meets the Performance Requirements of NZBC Clauses B2, Durability (B2.3.1[b] 15 years and B2.3.2), E2 External Moisture, and F2 Hazardous Building Materials.

**Thermakraft ALUBAND™** is expected to have a serviceable life equal to that of the cladding, when installed in accordance with this “Application and Installation” sheet, provided it is not exposed to the weather or ultra-violet (UV) for a total of no more than 90 days, or damaged on installation.

**Thermakraft ALUBAND™** is designed to work on all kraft based building underlays that meet the requirements of NZBC E2/AS1 Table 23, and on all **Thermakraft** BRANZ appraised wall underlays.

**Thermakraft ALUBAND™** should be installed when temperatures are above +10°C - +30°C.

At temperatures below 10°C, the following cold weather installation may be required:-

1. Follow application and installation steps 1-3.
2. At step 4 remove the polyethylene release film from the **ALUBAND™** tape. Align the back edge of the **ALUBAND™** with the inside of the sill, and press into place.
3. **USING A HEAT GUN SET ON LOW, APPLY HEAT** to the top of the **ALUBAND™** tape (logo facing up). The **ALUBAND™** adhesive will soften. Ensure during heating that the **ALUBAND™** surface is not damaged or melted.  
**NOTE:** Take care not to apply excess heat, as this may melt or damage the wall underlay.
4. Whilst the **ALUBAND™** is warm to touch, and using the **Thermakraft Aluband Tool**, firmly press the **ALUBAND™** onto the wall underlay to ensure good adhesion. Using the **Thermakraft Aluband Tool**, ensure the tape is fitted tightly into the jamb to sill corners.

**Thermakraft ALUBAND™** must not be left exposed to the elements for more than 90 days.

---

The recommendations contained in **Thermakraft's** literature are based on good building practice, but are not an exhaustive statement of all relevant information and are subject to any conditions contained in the Warranty. All product dimensions and performance claims are subject to any variation caused by normal manufacturing process and tolerances. Furthermore, as the successful performance of the relevant system depends on numerous factors outside the control of **Thermakraft** (for example quality of workmanship and design), **Thermakraft** shall not be liable for the recommendations in that literature and the performance of the **Product**, including its suitability for any purpose or ability to satisfy the relevant provisions of the Building Code, regulations and standards.

---



11 Turin Place, East Tamaki, Auckland, New Zealand  
PO Box 58-112, Botany, Manukau 2163, New Zealand  
Phone: 09-273 3727 Fax: 09-273 3726 Free Phone: 0800 806 595  
Email: sales@thermakraft.co.nz Website: www.thermakraft.co.nz